

# WALL 1

## LVH44 AIR TRANSFER GRILLE FITTED INTO MASONRY WALL WITH ANGLE FIXINGS

### DESCRIPTION

- 1 Masonry or concrete wall
- 2 Lorient intumescent sealant around LVH44 perimeter to a maximum clearance of 25mm
- 3 Lorient LVH44 intumescent air transfer grille
- 4 **Fixing angle:** 20 x 20 x 1mm thick minimum galvanised steel angles fixed to air transfer grille unit with self tapping screws and to wall with masonry anchors

**Fixing option 1:** 20mm wide angle tabs, central to all four sides or at 200mm maximum centres

**Fixing option 2:** Full width angles top and bottom only with 200mm fixing centres

In order to comply with CF564, the upper edge of the grille shall be no higher than 3000mm from floor level. The lower edge of the grille shall be no closer than 200mm to floor level.

### CONTENTS

- LVH44 air transfer grille
- Cover grille (optional)
- Steel angles (optional)

### TOOLS REQUIRED

- Angle fixings
- Self tapping screws (3.5 x 16mm)
- Masonry anchors
- Lorient intumescent sealant

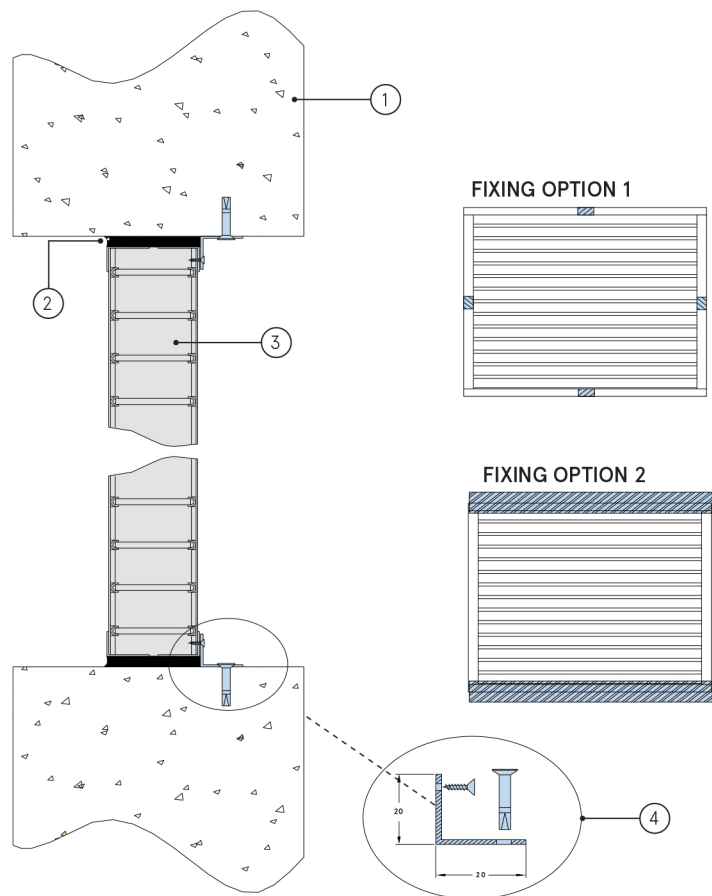

**certifire**  
(CF564)

### LVH44 for masonry wall with angle fixings

#### FR120

#### Fire Resistance in accordance with

BS 476-22:1987

#### Approval Ref

WFRC 121316 (AW1)  
CF564\*

#### Max single cell size

Any rectangular shape up to 600 x 600mm  
\*0.2025m<sup>2</sup>

LVH44 air transfer grilles are supplied 2mm less than the nominal size e.g. a 300mm x 300mm is actually 298mm x 298mm.

### INSTALLATION INSTRUCTIONS

- ▶ Fix the mounting angles onto the LVH44 air transfer grille using self tapping screws to **one side only**.
- ▶ Insert LVH44 into masonry wall opening. (Note: air transfer grille does not have to be centrally positioned in the opening).
- ▶ Fix the angles to the masonry wall with masonry anchors.
- ▶ Apply a bead of Lorient intumescent sealant around the perimeter of LVH44 as shown (note: maximum clearance of 25mm applies).
- ▶ Connect ductwork (or cover grille) directly to wall using approved breakaway connections to ensure compliance.
- ▶ **Note: Fixings supplied by others.**