

Technical Data Sheet

Rytons '9x9' Ventilation Set with Louvre Ventilator (Light and Draught Reducing)

www.vents.co.uk (search code: TCL20)

May 2010

Dimensional Drawing (Rytons TCL20000)

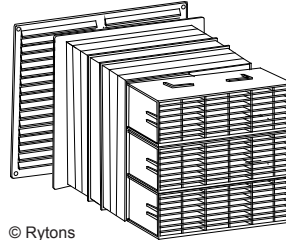
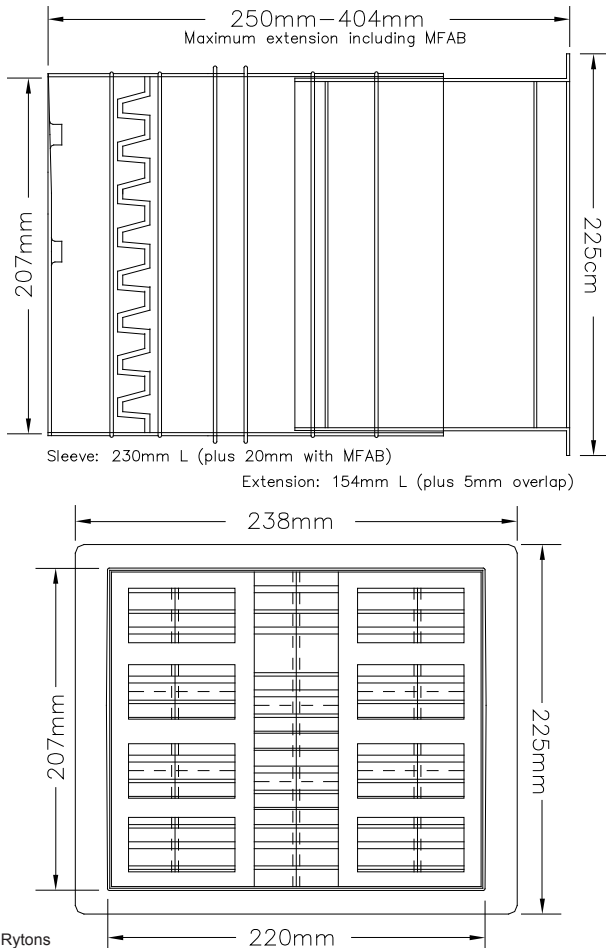

© Rytons

Approvals and Testing



Main Uses, Features and Benefits

- Combustion air vent for heat producing appliances.
- Room or compartment ventilator.
- Provides over 160cm² equivalent area.
- Equivalent area calculated by the BRE at 15 Pa to BS 5440-2:2000.
- HETAS approved for use with solid fuel appliances.
- Internal baffles reduce light and draughts.
- Finished with a fixed open louvre ventilator.
- Set contains Rytons Multifix® Air Bricks (MFAB) x3, Rytons '9x9' Telescopic AirLiner® (TCL20000) and Rytons Louvre Ventilator '9x9' (LV265).
- U.V. stabilised air bricks and louvre ventilator to protect against deterioration by sunlight.



F30 Accessories/Sundry Items for Brick/Block/Stone Walling

Specification clauses 17, 171

U90 General Ventilation - Domestic

Specification clauses 30, 34, 310, 340

Product Specification Code	Equivalent Area
Rytons TCL20	16580mm ² (165.8cm ²) (25½"²)

In-Situ Line Drawing

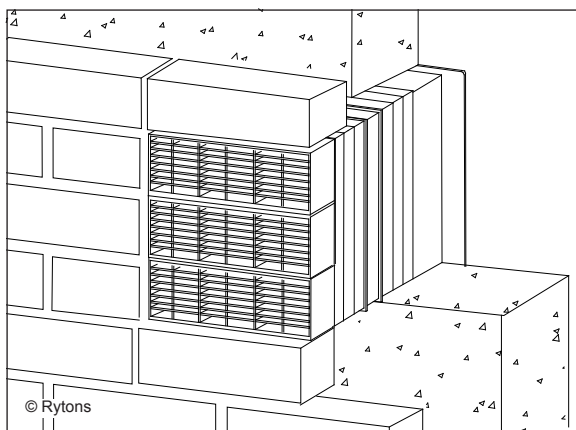

© Rytons

Size

MFAB & TCL20000: 220mm (W) x 207mm (H).

Extends from 250mm to 404mm (L) with Rytons Multifix® Air Bricks fitted.

LV265: 271mm (L) x 247mm (H).

Gas Appliances

Suitable for an open-flued gas appliance installed in a room or internal space with a gross rated input up to 40kW (136480 Btu/h).

Solid Fuel Appliances

(e.g. Stoves, Range Cookers or Independent Boilers)

Closed appliance without a draught stabiliser fitted - suitable up to 35kW.

Closed appliance with a draught stabiliser fitted - suitable up to 22kW.



Technical Data Sheet

www.vents.co.uk (search code: TCL20)

Rytons '9x9' Ventilation Set with Louvre Ventilator (Light and Draught Reducing)

May 2010

Colour Key

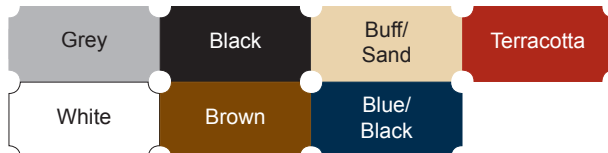

Photo Library



Composition

MFAB: U.V. stabilised polypropylene.

TCL20000: Polypropylene. **Contains recycled plastic.**

LV265: U.V. stabilised high impact polystyrene.

Colours

MFAB: Grey, black, buff/sand, terracotta, white, brown, blue/black.

TCL20000: Black.

LV265: White.

Specification Paragraph

Manufacturer: Rytons Building Products Ltd

T: 01536 511874, F: 01536 310455, E: admin@rytons.com

Visit our website at www.vents.co.uk

Product ref:

- Rytons '9x9' Ventilation Set with Louvre Ventilator Grey (ref TCL20GR)
- Rytons '9x9' Ventilation Set with Louvre Ventilator Black (ref TCL20BL)
- Rytons '9x9' Ventilation Set with Louvre Ventilator Buff/Sand (ref TCL20BS)
- Rytons '9x9' Ventilation Set with Louvre Ventilator Terracotta (ref TCL20TC)
- Rytons '9x9' Ventilation Set with Louvre Ventilator White (ref TCL20WH)
- Rytons '9x9' Ventilation Set with Louvre Ventilator Brown (ref TCL20DB)
- Rytons '9x9' Ventilation Set with Louvre Ventilator Blue/Black (ref TCL20BB)

Type: Telescopic Liner with Multifix® Air Bricks and Louvre Ventilator

Equivalent Area: 16580mm² (BRE tested)

Installation

No special fixing required. Build in cavity liner with fitted air bricks as work proceeds. Extend telescopic sleeve as necessary. Fasten louvre ventilator internally covering the flange of the AirLiner®. Consideration should be given to using Rytons '9x9' Cowl (ABC9) in exposed areas.

HETAS Approval

HETAS is the official body recognised by the government to approve solid fuel domestic heating appliances, fuels and services. Rytons is the only ventilation manufacturer to have solid fuel appliance ventilators approved by HETAS and is the only ventilation manufacturer recommended by HETAS to their registered engineers.

A bit about the BRE

The Building Research Establishment Ltd is a respected independent testing authority. Since 2006 Rytons has commissioned the BRE to calculate the equivalent free area of their heat producing appliance and background ventilators giving installers, suppliers and homeowners the confidence that the air space is **accurate** and **verifiable**.

Technical Data Sheet

Rytons '9x9' Ventilation Set with Louvre Ventilator (Light and Draught Reducing)

www.vents.co.uk (search code: TCL20)

May 2010

Extra Features and Benefits

Individually boxed sets for easy identification, handling and efficient installation.

Air brick louvres promote unrestricted air flow and reduce risk of blockage as well as keeping large insects out. Also features built-in water baffles to prevent water penetration.

External AirLiner® baffles prevent water transfer across the cavity.

Low profile louvre ventilator maintains a neat internal appearance.

Louvre embossed with DO NOT BLOCK.

UK Regulations, Standards and Guidelines

For heat producing appliances (including solid fuel) refer to:

The Building Regulations 2000, Approved Document J.

The Building (Scotland) Regulations 2005, Mandatory Standard 3.21.

The Building Regulations (Northern Ireland) 2000, Technical Booklet L.

British Standard BS 5440-2:2009.

For decorative fuel effect gas fires refer to:

British Standard BS 5871-3:2005.

Handling Information

Box quantity: 1 set

Box size: 27.5cm (W) x 28.5cm (H) x 27cm (D).

Box weight: 1.36kg

Questions

Is a cowl option available for exposed areas?

Yes, refer to technical data sheet TCL20CW.

Is an acoustic option available?

Yes, refer to technical data sheet TAL9SET.



Please recycle printouts where facilities exist.

